



Luminaire Schedule: HBMD ADMIN BUILDING EXPANSION - SITE_rev01 POMPANO BEACH, FL 06/28/2023											
Symbol	Qty	Label	Arrangement	Manufacturer	Catalog Number	Mounting	LLF	Luminaire Lumens	Luminaire Watts	Arrangement Watts	BUG Rating
	4	SA	Single	Lithonia Lighting	DSX0 LED P1 40K 80CRI BLC3	POLE MOUNT A.F.G.	0.855	5869	68.95	68.95	B0-U0-G2
	3	SB	Single	Lithonia Lighting	DSX0 LED P1 40K 80CRI RCOO	POLE MOUNT A.F.G.	0.855	3227	33.21	33.21	B0-U0-G1
	1	SC	Single	Lithonia Lighting	DSX0 LED P1 40K 80CRI LCOO	POLE MOUNT A.F.G.	0.855	3227	33.21	33.21	B0-U0-G1
	13	W	Single	Browlee Lighting Inc	7075-12-TW-H21-40K	WALL MOUNT A.F.F. (top of fixture)	0.898	1696	20.83	20.83	B1-U0-G1

Calculation Summary: HBMD ADMIN BUILDING EXPANSION - SITE_rev01 POMPANO BEACH, FL 06/28/2023							
Label	Calc Type	Units	Avg	Max	Min	Avg/Min	Max/Min
BUILDING PERIMETER	Illuminance	Fc	1.83	7.2	0.0	N.A.	N.A.
PARKING LOT	Illuminance	Fc	2.11	3.1	1.1	1.92	2.82
PROPERTY LINE EAST (5' above grade)	Illuminance	Fc	0.00	0.0	0.0	N.A.	N.A.
PROPERTY LINE SOUTH (5' above grade)	Illuminance	Fc	0.04	0.5	0.0	N.A.	N.A.

N.W. 30TH AVE - BLOUNT RD.

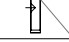
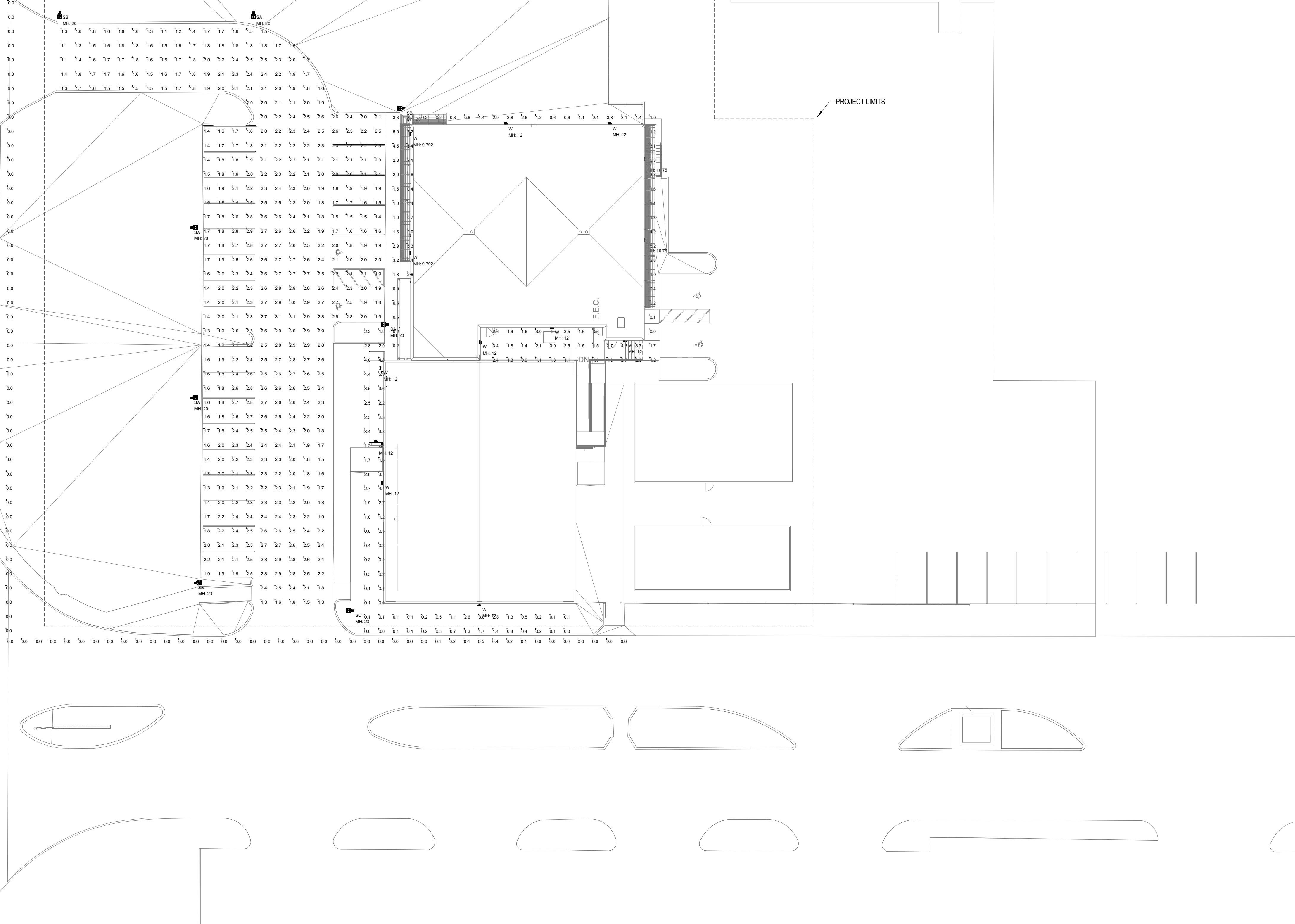

1 ELECTRICAL - SITE PHOTOMETRY PLAN
SCALE: 1" = 20'-0"

SCHEMATIC DESIGN
HBMD ADMIN BUILDING EXPANSION
BROWARD COUNTY
1400 BLOUNT RD
POMPANO BEACH FL 33069



3501 Griffin Road
Ft. Lauderdale, FL 33312
(954) 266-2700 Fx:(954) 266-2701
sma@saltzmichelson.com

AA-0002897

HAMMOND & ASSOCIATES, INC.

CONSULTING ENGINEERS
499 N.W. 70TH AVENUE, SUITE 201
PLANTATION, FLORIDA 33317
TEL: (954) 327-7111
JOHN G. CUMPER P.E.
MECHANICAL / ELECTRICAL ENGINEER
P.E. #53273
EB 5315



Project No. :
2022-104
Drawn By :
Author
Checked By :
Checker
Date:
02.10.2023

REVISIONS

ELECTRICAL SITE
PHOTOMETRY PLAN

PROGRESS SET | NOT FOR CONSTRUCTION
2023-10-000012
08/16/2023
FL 02